



SUNRISE
MEDICAL



Edition: 11,24
Valid until: 11.25

Life R

Invoice to:

Name:

Street:

Town:

Postal code:

E-Mail:

Tel:

Fax:



Deliver to:

Name:

Street:

Town:

Postal code:

E-Mail:

Tel:

Fax:

Order date:

Purchase order:

Number required:

Marked for:

Sunrise order no:

☐ Order ☐ Calculation ☐ Built 4 me

• = Standard
○ = No cost option

☐ = Cost option

Art. no.: 84400101

Max. user weight: 125 kg

USER WEIGHT

kg

Mandatory information to ensure correct configuration

Base Price 2.475 €

CLIENT MEASUREMENT (all measurements in mm without cushion)

SEAT WIDTH SELECTION - measured from outside frame tube to outside frame tube (mm)

340	360	380	400	420	440	460	480
<input type="radio"/>	<input type="radio"/>	<input type="radio"/>	<input type="radio"/>	<input type="radio"/>	<input type="radio"/>	<input type="radio"/>	<input type="radio"/>

SEAT DEPTH SELECTION - measured in mm

360	380	400	420	440	460	480	500
<input type="radio"/>	<input type="radio"/>	<input type="radio"/>	<input type="radio"/>	<input type="radio"/>	<input type="radio"/>	<input type="radio"/>	<input type="radio"/>
Short Frame			Medium Frame			Long Frame	

FRONT SEAT HEIGHT SELECTION: in dependance of front castors and frame versions

		Front seat height (mm)												
		Fork type (mm)	390	400	410	420	430	440	450	460	470	480	490	500
Front Castor	4"	Aluminium (143mm)	<input type="radio"/>	<input type="radio"/>	<input type="radio"/>	<input type="radio"/>	<input type="radio"/>	<input type="radio"/>	<input type="radio"/>	<input type="radio"/>	<input type="radio"/>	<input type="radio"/>	<input type="radio"/>	<input type="radio"/>
		Aluminium (158mm)	<input type="radio"/>	<input type="radio"/>	<input type="radio"/>	<input type="radio"/>	<input type="radio"/>	<input type="radio"/>	<input type="radio"/>	<input type="radio"/>	<input type="radio"/>	<input type="radio"/>	<input type="radio"/>	<input type="radio"/>
	5"	Aluminium (143mm)	<input type="radio"/>	<input type="radio"/>	<input type="radio"/>	<input type="radio"/>	<input type="radio"/>	<input type="radio"/>	<input type="radio"/>	<input type="radio"/>	<input type="radio"/>	<input type="radio"/>	<input type="radio"/>	<input type="radio"/>
		Aluminium (158mm)	<input type="radio"/>	<input type="radio"/>	<input type="radio"/>	<input type="radio"/>	<input type="radio"/>	<input type="radio"/>	<input type="radio"/>	<input type="radio"/>	<input type="radio"/>	<input type="radio"/>	<input type="radio"/>	<input type="radio"/>
	6"	Aluminium (143mm)	<input type="radio"/>	<input type="radio"/>	<input type="radio"/>	<input type="radio"/>	<input type="radio"/>	<input type="radio"/>	<input type="radio"/>	<input type="radio"/>	<input type="radio"/>	<input type="radio"/>	<input type="radio"/>	<input type="radio"/>
		Aluminium (158mm)	<input type="radio"/>	<input type="radio"/>	<input type="radio"/>	<input type="radio"/>	<input type="radio"/>	<input type="radio"/>	<input type="radio"/>	<input type="radio"/>	<input type="radio"/>	<input type="radio"/>	<input type="radio"/>	<input type="radio"/>
	7"	Aluminium (158mm)	<input type="radio"/>	<input type="radio"/>	<input type="radio"/>	<input type="radio"/>	<input type="radio"/>	<input type="radio"/>	<input type="radio"/>	<input type="radio"/>	<input type="radio"/>	<input type="radio"/>	<input type="radio"/>	<input type="radio"/>
		Aluminium (158mm)	<input type="radio"/>	<input type="radio"/>	<input type="radio"/>	<input type="radio"/>	<input type="radio"/>	<input type="radio"/>	<input type="radio"/>	<input type="radio"/>	<input type="radio"/>	<input type="radio"/>	<input type="radio"/>	<input type="radio"/>

Max. difference front/ rear seat height: 0 - 110 mm

REAR SEAT HEIGHT SELECTION: in dependance of rear wheel size

		Rear seat height (mm)											
Wheels		360	370	380	390	400	410	420	430	440	450	460	470
22"		<input type="radio"/>	<input type="radio"/>	<input type="radio"/>	<input type="radio"/>	<input type="radio"/>	<input type="radio"/>	<input type="radio"/>	<input type="radio"/>	<input type="radio"/>	<input type="radio"/>	<input type="radio"/>	<input type="radio"/>
24"		<input type="radio"/>	<input type="radio"/>	<input type="radio"/>	<input type="radio"/>	<input type="radio"/>	<input type="radio"/>	<input type="radio"/>	<input type="radio"/>	<input type="radio"/>	<input type="radio"/>	<input type="radio"/>	<input type="radio"/>
25"		<input type="radio"/>	<input type="radio"/>	<input type="radio"/>	<input type="radio"/>	<input type="radio"/>	<input type="radio"/>	<input type="radio"/>	<input type="radio"/>	<input type="radio"/>	<input type="radio"/>	<input type="radio"/>	<input type="radio"/>

For more information
www.SunriseMedical.eu
© Sunrise Medical 2024

Please follow this measuring method:

The following method is recommended on the basis of extensive practical experience. Deviations are possible in individual instances.

Seat width (SW):

- a) For the user: Allow space between sideguard and hip on each side of the chair
(approx. 10 - 20 mm altogether)
- b) On the wheelchair: From outside frame tube to outside frame tube.

Seat depth (SD):

- a) For the user: When sitting upright: leave space for 2 - 3 fingers between
front edge of the seat upholstery and back of knee.
(approx. 30 - 60 mm). Care must be taken with adj. upholstery.
- b) On the wheelchair: From back tube to front of seat upholstery.

Front seat height:

- a) For the user: When sitting with 90° kneeangle:
From back of knee to bottom of shoe sole.
- b) On the wheelchair: From front of seat tube to the ground.
(min. 30 mm longer than user measurement)
Remember to include the cushion height.

Rear seat height:

- b) On the wheelchair: From back of seat tube to the ground.
Note: Max. seat height difference rear to front is 130 mm

Back height:

- a) For the user: From the seat, including cushion, to be no more than 10 - 20 mm below the lower shoulder blade.
- b) On the wheelchair: From back of seat tube to upper edge of backrest upholstery.
Note: The user's ability to sit upright has a major influence on the
back height and it can therefore differ considerably

Back angle:

Important: The back height depends on the degree of disability.
0° is the angle 90° to the ground. Negative angles are < 90°
and positive angles are > 90°.

Quickie Life R

● = Standard ○ = No cost option □ = Cost option

€

SEAT UPHOLSTERY AND CUSHIONS

Seat Slings

LRF020001	●	Seat sling, Nylon, tension adjustable	Std
LRF020002	□	Seat sling, nylon, tension adjustable, 1 utility bag	26 €
LRF020000	○	Without seat sling	-

Seat Cushion with black cover

LRF020101	□	Seat cushion, foam (medium-soft), cover with zipper, black, 30 mm	110 €
LRF020102	□	Seat cushion, foam (medium-soft), cover with zipper, black, 50 mm	110 €

Jay Cushion - for complete Jay product range see Jay order forms

JAY020002	□	JAY Basic	155 €
JAY020003	□	JAY Soft Combi P	227 €
JAY020001	□	JAY Easy Visco C	333 €
JAY020007	□	JAY Easy Fluid	573 €
JAY020004	□	JAY LITE	525 €

Seat accessories

LRF090018	□	Lap belt with buckle, metal	83 €
-----------	---	-----------------------------	------

BACKREST

Backrest height range	250 - 300	300 - 350	350 - 400	400 - 450
Back height set at (mm)	○ 250	○ 300	○ 350	○ 400
	○ 275	○ 325	○ 375	○ 425
	○ 300	○ 350	○ 400	○ 450

LRF030001	●	Backrest tube, aluminum	(from BH 275mm)	Std
LRF030015	□	Backrest, angle-adjustable, fold-down		272 €
		LRF030512 ○ 78° LRF030518 ○ 82° LRF030514 ○ 86°		-
		LRF030500 ○ 90° LRF030504 ○ 94° LRF030508 ○ 98°		-
LRF030102	□	Backrest, angle-adjustable, lock when folded	(only with angle adj back)	70 €

Push handles

LRF030201	○	Push handles long	-
LRF030200	○	Without push handles	-
LRF030203	□	Push handles, fold-down	(only from back height 300mm) 186 €
LRF030204	□	Push handles, height-adjustable	(only from back height 300mm) 295 €
LRF030205	□	Push handles, height-adjustable for Jay backs	(only from back height 300mm) 295 €

Head rest

LRF030410	□	Headrest, tall height, depth and angle-adjustable, 230 x 110 mm	(Only with push handles height adjustable) 392 €
LRF030411	□	Headrest, medium height, depth & angle-adjustable, 200 x 110 mm	(Only with push handles height adjustable) 392 €

Backrest upholstery (black)

LRF030316	○	EXO Backrest sling, padded, adjustable, 1 accessory bag, black (EXO Evo version)	-
		Colour, binding tape: ● Black ○ Orange ○ Silver ○ Red ○ Blue	-
LRF030317	□	EXO PRO Backrest, padded, adj., breathable spacer fabric, 1 accessory bag, black (EXO Evo version)	170 €
		Colour, binding tape: ● Black ○ Orange ○ Silver ○ Red ○ Blue	-
LRF030000	○	Without backrest upholstery	-

For more information

www.SunriseMedical.eu

© Sunrise Medical 2024

SEAT UPHOLSTERY AND CUSHIONS



Seat cushion, cover with zipper, black



Jay Basic
(picture shown without upholstery)



Jay Soft Combi P
(picture shown without upholstery)

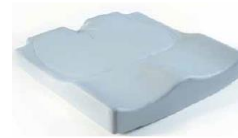

Jay Easy Visco
(picture shown without upholstery)



Jay Easy Fluid
(picture shown without upholstery)



Jay Lite



Lap belt with buckle, metal

BACKREST



Backrest, angle-adjustable, lock when folded



Push handles long



Fold down push



Height adjustable push handles



EXO
backrest sling (new
EXO Evo version)



EXO PRO
backrest sling (new
EXO Evo version)

Quickie Life R			
● = Standard ○ = No cost option □ = Cost option			€
JAY BACKS plus ACCESSORIES - for complete Jay product range see Jay order forms			
Jay 3 Back - Shallow Contour (SC)			
Mid Thoracic:	□ JAY030010	Medium 340 mm	□ JAY030033 Tall 380 mm 846 €
Upper Thoracic:	□ JAY030012 Short 420 mm	□ JAY030019 Medium 460 mm	□ JAY030025 Tall 500 mm 939 €
Shoulder Height:	□ JAY030015 Short 530 mm	□ JAY030022 Medium 570 mm	□ JAY030028 Tall 610 mm 1.006 €
Jay 3 Back - Mid Contour (MC)			
Mid Thoracic:	□ JAY030011	Medium 340 mm	□ JAY030018 Tall 380 mm 926 €
Upper Thoracic:	□ JAY030013 Short 420 mm	□ JAY030020 Medium 460 mm	□ JAY030026 Tall 500 mm 1.033 €
Shoulder Height:	□ JAY030016 Short 530 mm	□ JAY030023 Medium 570 mm	□ JAY030029 Tall 610 mm 1.087 €
Jay 3 Back - Mid Deep Contour (MDC)			
Mid Thoracic:	□ JAY030044	Medium - 340 mm	□ JAY030041 Tall 380mm 1.062 €
Upper Thoracic:	□ JAY030045 Short - 420 mm	□ JAY030042 Medium 460mm	□ JAY030046 Tall - 500 mm 1.062 €
Shoulder Height:	□ JAY030043 Short 530mm	□ JAY030047 Medium - 570 mm	□ JAY030048 Tall - 610 mm 1.087 €
JAY J3 Back - Mid Deep Contour (MDC) (Extra Deep, 180 mm contour depth)			
Mid Thoracic:		□ JAY030049 Tall - 380 mm	1.062 €
Upper Thoracic:	□ JAY030050	Medium - 570 mm	1.062 €
Jay 3 Back - Deep Contour (DC)			
Upper Thoracic:	□ JAY030014 Short 420 mm	□ JAY030021 Medium 460 mm	□ JAY030027 Tall 500 mm 1.114 €
Shoulder Height:	□ JAY030017 Short 530 mm	□ JAY030024 Medium 570 mm	□ JAY030030 Tall 610 mm 1.141 €
WHT030415	□ Whitmyer Headrest, COBRA XTRA, Flip back	(only with JAY J3 Backs)	538 €
WHT030416	□ Whitmyer Headrest, AXYS, Standard	(only with JAY J3 Backs)	322 €
ARMREST AND SIDEGUARDS			
Armrest (choose only one option, not in combination with sideguards; only with 0° and 1° camber)			
LRF040050	□ Single-post sideguard, height-adjustable, removable, armpad (250 mm),		252 €
LRF040051	□ Single-post sideguard, height-adjustable, removable, armpad (360 mm),		252 €
LRF040052	□ Single-post sideguard, depth adjustable, tool height-adjustable, removable, armpad (330 mm)		252 €
Sideguards (not in combination with armrest)			
LRF040107	□ Sideguard, composite, removable, 210 mm high (310 mm long), black		-
LRF040102	□ Sideguard, aluminium, cold weather protection (in frame colour)	(effective seat width is sw + 20mm)	227 €
LRF040103	□ Sideguard, aluminium, fender, cold weather protection (in frame colour)	(effective seat width is sw + 20mm)	276 €
LRF040104	□ Sideguard, carbon fibre, fender, cold weather protection (black)	(effective seat width is sw + 20mm)	287 €
FRAME			
LRF010010	○ Frame FF 75 ° (integrated footrest)	(LLL from 340 mm)	-
LRF010011	□ Frame FF 85 ° (integrated footrest)		
LRF010016	□ Frame FF 85 ° (integrated footrest), inset (20 mm on each side), active		153 €
LRF010015	□ Frame SA (removable footrest)		
LRF090100	□ Tie down brackets for transportation		89 €
CENTER OF GRAVITY (COG) measured from front of back post; choose only one option			
COG23	○ Centre of gravity 23 mm		-
COG43	● Centre of gravity 43mm		Std
COG63	○ Centre of gravity 63mm		-
COG83	○ Centre of gravity 83mm		-
Frame accessories			
LRF010500	□ Wheelbase extension for add-on bike	(1)	274 €
LRF090010	□ Transit wheels	(Not with crutch holder, tip assist and anti tip)	272 €
Tip assist (step tube) & Crutch holder (choose either tip assist or anti- tip tubes, not both)			
LRF090001	□ Tip assist, left	LRF090002 □ Tip assist, right	68 €
LRF090003	□ Tip assist, pair		137 €
LRF090009	□ Crutch holder, loop	(only in combination with tip assist)	39 €
Anti-tip tubes, swing-away (choose either tip assist or anti- tip tubes, not both)			
LRF090004	□ Anti-tip tubes, swing-away, left	LRF090005 □ Anti-tip tubes, swing-away, right	159 €
LRF090006	□ Anti-tip tubes, swing-away, pair		317 €
LRF090036	□ Anti-tip tubes, aluminium, lightweight, swing-away (forwards), pair (max user weight 100kg)		317 €
(1) (max 100 kg user weight; not with drumbrake, crutch holder, tip assist, anti tip, wheel drive)			For more information www.SunriseMedical.eu © Sunrise Medical 2024

JAY J3 Backs

JAY J3 Back
Shallow Contour



JAY J3 Back
Mid Contour



JAY J3 Back
Mid Deep Contour



JAY J3 Back
Deep Contour



ARMREST AND SIDEGUARDS



Single post height
adjustable armrest



Single-post sideguard,
depth adjustable, tool
height-adjustable



Sideguard composite
detachable



Sideguard carbon with
fender



Sideguard alu with fender



Desk armrest,
height adjustable, short armpad(25cm)



Desk armrest,
fixed height, short armpad(25cm)



Desk armrest
without armpad

Frame



Life SA



Life FF 85°



Life FF 75°



Frame FF 85°
(integrated footrest),
inset (20 mm on each
side), active

FRAME ACCESSORIES



Transit wheels



Tip assist



Crutch holder



Anti-tip swing away

Quickie Life R		
<input checked="" type="radio"/> = Standard <input type="radio"/> = No cost option <input type="checkbox"/> = Cost option		€
PREPARATION FOR ATTITUDE ADD-ON BIKE - only with FF-Frame		
LRF090211	<input type="checkbox"/> Preparation for ATTITUDE, w/o ATTITUDE order (docking pins assembled)	
LRF090212	<input type="radio"/> Preparation for ATTITUDE, with ATTITUDE order (docking pins assembled; ATTITUDE order separately)	110 €
EMPULSE F55 BUNDLING		
EMO000101	<input type="radio"/> With F55 order, not mounted to the wheelchair (Please use separate OF to order the F55.)	
EMO000102	<input type="radio"/> With F55 order, mounted to the wheelchair (Please use separate OF to order the F55.)	208 €
HANGERS & FOOTPLATES		
LRF050002	<input type="radio"/> Hanger angle 70°	-
LRF050001	<input type="radio"/> Hanger angle 80°	-
LRF050041	<input type="radio"/> Hanger angle 90° (not with 6" & 7" castor)	-
LRF050008	<input type="checkbox"/> Hanger, aluminium, swing-away, pair	164 €
LRF050006	<input type="checkbox"/> Hanger, aluminium, swing-away, LH LRF050007 <input type="checkbox"/> Hanger, aluminium, swing-away, RH	83 €
Composite hanger		
LRF050002	<input type="radio"/> Hanger angle 70°	-
LRF050001	<input type="radio"/> Hanger angle 80°	-
LRF050005	<input type="checkbox"/> Hanger, composit, swing-away, pair	-
LRF050003	<input type="checkbox"/> Hanger, composit, swing-away, LH LRF050004 <input type="checkbox"/> Hanger, composit, swing-away, RH	-
Elevating Legrest (ELR)		
LRF050011	<input type="checkbox"/> Hanger, aluminium, flip-up (0° - 90°), swing-away, pair (1) (from seat width 380 mm)	293 €
LRF050009	<input type="checkbox"/> Hanger, aluminium, flip-up (0° - 90°), swing-away, LH (1)	147 €
LRF050010	<input type="checkbox"/> Hanger, aluminium, flip-up (0° - 90°), swing-away, RH (1)	147 €
Footplate		
LRF050020	<input checked="" type="radio"/> Footboard, divided, composit, angle-adjustable, flip-up (sideways), heel loop, black (2)	Std
LRF050050	<input type="checkbox"/> Footboard, divided, aluminum, angle-adjustable, flip-up (sideways), heel loop, black (from LLL 350 mm)	254 €
LRF050102	<input type="checkbox"/> Footboard, platform, aluminum, angle-adjustable, flip-up (sideways), heel loop, black (3) (from LLL 340 mm)	188 €
	LRF050126 <input type="checkbox"/> Swing-away mechanism for platform footboard	188 €
	LRF050062 <input type="checkbox"/> Locking system, platform footplate, aluminium	65 €
Platform footrest, angle adjustable (only for seat width 320 to 500 mm)		
LRF050131	<input type="checkbox"/> Footboard, platform, lightweight, composite, angle & depth-adjustable flip up, calf strap black (4)	164 €
LRF050132	<input type="checkbox"/> Footboard, platform lightweight, carbon fibre, angle & depth-adjustable flip-up, calf strap, black (4)	217 €
LRF050127	<input type="checkbox"/> Adjustable side protection, to create a side-stop on the footboard (only in combination with Platform)	68 €
Footrest (only with fixed front frame) (not with hanger; lower leg length between 360 mm - 525 mm)		
LRF050025	<input type="checkbox"/> Footboard, platform, lightweight, composite, angle and depth-adjustable, calf strap, black	116 €
LRF050024	<input type="checkbox"/> Footboard, platform, lightweight, aluminum, angle and depth-adjustable, calf strap, frame colour	116 €
LRF050127	<input type="checkbox"/> Adjustable side protection, to create a side-stop on the footboard (only with LIR050025/050024/050032)	68 €
LOWER LEG LENGTH (LLL in mm) (Attention: LLL has to be 25 mm lower than seat height front)		
<input type="radio"/> 330 <input type="radio"/> 340 <input type="radio"/> 350 <input type="radio"/> 360 <input type="radio"/> 370 <input type="radio"/> 380 <input type="radio"/> 390 <input type="radio"/> 400 <input type="radio"/> 410 <input type="radio"/> 420 <input type="radio"/> 430 <input type="radio"/> 440 <input type="radio"/> 450 <input type="radio"/> 460 <input type="radio"/> 470		
FORK (compare with your choice on the first page)		
LRF080029	<input checked="" type="radio"/> Castor fork, Aluminium, black	Std
LRF080042	<input type="checkbox"/> Colour Cast. Fork Silver	50 €
Castor fork alu powder coated		
<input type="checkbox"/> 16 Matt Marine		50 €
<input type="checkbox"/> 21 Red Ruby		50 €
<input type="checkbox"/> 32 Signal White		50 €
<input type="checkbox"/> 37 Marsred (Orange)		50 €
CASTOR (compare with your choice on the first page)		
LRF080301	<input type="radio"/> Castor, solid (hard), rim: composite, black	-
LRF080302	<input type="radio"/> Castor, solid (soft), rim: composite, black (only for 5" & 6" castors; max SH 520mm)	-
LRF080305	<input type="radio"/> Castor, pneumatic, rim: composite, black (only for 6" & 7" castors)	-
LRF080303	<input type="checkbox"/> Castor, solid (hard), light-up, rim: composite, black (Not available for 6"/7")	72 €
Castor with aluminium rim		
LRF080304	<input type="checkbox"/> Castor, solid (hard), rim: aluminium (Only for 4" and 5")	98 €
LRF080306	<input type="checkbox"/> Castor, solid (soft), rim: aluminium, silver (Only for 4" and 5";)	148 €
Colour, rim: <input type="checkbox"/> Black <input type="checkbox"/> Orange <input type="checkbox"/> Red <input type="checkbox"/> Blue		50 €
(1): Not in combination with platform footboard (2): pair; from LLL 330 mm; only from SW 360 mm, with inset from sw 400mm (3): from LLL 350 mm; not in combination with ELR (4): not with ELR		For more information www.SunriseMedical.eu © Sunrise Medical 2024

FRAME ACCESSORIES



Aluminum hanger, 90°



Hanger Angle 70°/80°



Elevating legrest

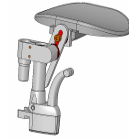

Amputee Support Pad



Platform footplate lightweight angle & depth adjustable composite flip up



Divided footplate composite



Divided footplate aluminum



Platform, angle and depth adjustable flip up, aluminium with locking system

FORKS



Fork Aluminium, black, orange & silver

F55 BUNDLING - NOGO MATRIX FOR SWING AWAY with 24" REAR WHEELS

COG	Seat Depth						
	380	400	420	440	460	480	500
40	✓	✓	✓	✓	✓	✓	✓
60	✗	✓	✓	✓	✓	✓	✓
70	✗	✓	✓	✓	✓	✓	✓
80	✗	✗	✓	✓	✓	✓	✓
90	✗	✗	✓	✓	✓	✓	✓
100	✗	✗	✗	✓	✓	✓	✓
110	✗	✗	✗	✓	✓	✓	✓
120	✗	✗	✗	✗	✓	✓	✓
130	✗	✗	✗	✗	✓	✓	✓

F55 BUNDLING - NOGO MATRIX FOR FIXED FRONT with 24" REAR WHEELS

COG	Seat Depth						
	380	400	420	440	460	480	500
40	✗	✗	✓	✓	✓	✓	✓
60	✗	✗	✗	✓	✓	✓	✓
70	✗	✗	✗	✓	✓	✓	✓
80	✗	✗	✗	✗	✓	✓	✓
90	✗	✗	✗	✗	✓	✓	✓
100	✗	✗	✗	✗	✗	✓	✓
110	✗	✗	✗	✗	✗	✓	✓
120	✗	✗	✗	✗	✗	✗	✓
130	✗	✗	✗	✗	✗	✗	✓

F35 BUNDLING - NOGO MATRIX FOR 24" REAR WHEELS

COG	Seat Depth						
	380	400	420	440	460	480	500
40	✗	✗	✓	✓	✓	✓	✓
60	✗	✗	✗	✓	✓	✓	✓
70	✗	✗	✗	✓	✓	✓	✓
80	✗	✗	✗	✗	✓	✓	✓
90	✗	✗	✗	✗	✓	✓	✓
100	✗	✗	✗	✗	✗	✓	✓
110	✗	✗	✗	✗	✗	✓	✓
120	✗	✗	✗	✗	✗	✗	✓
130	✗	✗	✗	✗	✗	✗	✓

Quickie Life R			
<input checked="" type="radio"/> = Standard <input type="radio"/> = No cost option <input type="checkbox"/> = Cost option			€
REAR WHEELS <small>(compare with your choice on the first page; choose only one wheel type)</small>			
LRF070000	<input type="radio"/> Without rear wheel		-
LRF070001	<input type="radio"/> Rear wheel, Universal, 36 spokes (silver), cross-wise spokes <small>(only 22"/24")</small>		-
LRF070002	<input type="radio"/> Rear wheel, Design, 36 spokes (silver), straight spokes <small>(only 24")</small>		-
LRF070003	<input type="checkbox"/> Rear wheel, Lightweight, 24 spokes (silver), straight spokes <small>(max. user weight: 125 kg)</small>		272 €
LRF070004	<input type="checkbox"/> Rear wheel, Proton, 24 spokes (black), straight spokes <small>(max. user weight: 100 kg)</small>		376 €
LRF070005	<input type="checkbox"/> Rear wheel, Spinergy, 18 spokes (black), straight spokes, hub: silver <small>(only 24"/25")</small>		678 €
LRF070008	<input type="checkbox"/> Rear wheel, drum brakes, 36 spokes (silver), cross-wise spokes <small>(only 22"/24")</small>		379 €
LRF070009	<input type="checkbox"/> Rear wheel, Mountainbike, 36 spokes (silver), straight spokes <small>(only 24")</small>		344 €
LRF070010	<input type="checkbox"/> Mountainbike wheel, replacement kit incl. tyre (extra coarse profile) <small>(only 24")</small>		522 €
TYRES <small>(choose only one tyre type)</small>			
LRF070101	<input type="radio"/> Tyre, pneumatic, fine profile, Schwalbe Right Run <small>(only 22"/24")</small>		-
LRF070102	<input type="radio"/> Tyre, puncture proof, tread <small>(25" only with Proton, lightweight wheel)</small>		-
LRF070107	<input type="checkbox"/> Tyre, pneumatic, slick, Schwalbe One <small>(only 24"/25")</small>		53 €
LRF070104	<input type="checkbox"/> Tyre, pneumatic, puncture proof, tread, Schwalbe Marathon Plus Evolution <small>(only 24"/25")</small>		54 €
LRF090163	<input type="checkbox"/> Spares-kit: 1 extra tyre (same as on the chair) and 1 extra inner tube <small>(not with solid tyres)</small>		67 €
HANDRIM			
LRF070202	<input type="radio"/> Handrims, aluminium, anodised, silver		-
LRF070201	<input type="radio"/> Handrims, aluminium, powder-coated, clear		-
LRF070204	<input type="radio"/> Handrims, stainless steel, silver		-
LRF070203	<input type="checkbox"/> Handrims, aluminium, powder-coated, coloured		68 €
LRF070207	<input type="checkbox"/> Handrims, Supergrip® <small>(22" only with universal and drum brake wheels)</small>		351 €
LRF070208	<input type="checkbox"/> Handrims, Maxgrepp® <small>(only 22"/24", 24" only handrim mounting narrow)</small>		463 €
LRF070212	<input type="checkbox"/> Handrims, Ellipse 3R, black <small>(ergonomic handrims with rubber-strip, 24" and 25" only)</small>		368 €
LRF070200	<input type="radio"/> Without handrims		-
HAND RIM MOUNTING			
LRF070307	<input type="checkbox"/> Handrim mount, super narrow (7 mm) <small>(Only with 24" stainless steel)</small>		126 €
			<small>(Only with 24" stainless steel; not in combination Spinergy, Proton and Lightweight wheels and stainless steel handrim)</small>
LRF070317	<input checked="" type="radio"/> Handrim mount, narrow (17 mm)		Std
LRF070327	<input type="radio"/> Handrim mount, wide (27 mm) <small>(not with Ellipse 3R, Maxgrepp 24")</small>		-
HAND RIM COVER			
LRF070250	<input type="checkbox"/> Handrim cover, Silicon <small>(not with 25", Supergrip, Maxgrepp)</small>		133 €
WHEEL CAMBER <small>(choose only one option; Armrests only with 0° & 1°)</small>			
LRF070600	<input checked="" type="radio"/> Camber 0°		Std
LRF070601	<input type="checkbox"/> Camber 1°	LRF070603 <input type="checkbox"/> Camber 3°	39 €
LRF070602	<input type="checkbox"/> Camber 2°	LRF070604 <input type="checkbox"/> Camber 4°	39 €
SPOKE GUARDS <small>(not with spinergy wheels, not with 25", not with mountainbike)</small>			
LRF070831	<input type="checkbox"/> Transparent		192 €
LRF070806	<input type="checkbox"/> Chrome		255 €
LRF070822	<input type="checkbox"/> Pool	LRF070820 <input type="checkbox"/> Oriental	255 €
LRF070811	<input type="checkbox"/> Feather	LRF070817 <input type="checkbox"/> Hot Wheels	LRF070802 <input type="checkbox"/> Basketball
LRF070814	<input type="checkbox"/> Graffiti	LRF070827 <input type="checkbox"/> Silk	255 €
LRF070828	<input type="checkbox"/> Space	LRF070812 <input type="checkbox"/> Flying Water	LRF070803 <input type="checkbox"/> Basketball 2
WHEEL LOCKS <small>(choose only one option)</small>			
LRF060001	<input type="radio"/> Standard brake		-
LRF060002	<input type="checkbox"/> Knee-lever brake		64 €
LRF060010	<input type="checkbox"/> Brake lever extension, knee-lever brake, fold-down		30 €
LRF060023	<input type="checkbox"/> Compact brake EVO		92 €
<div> <div></div> <div>For more information www.SunriseMedical.eu © Sunrise Medical 2024 </div> </div>			

REAR WHEELS



Universal cross spoked



Design wheel



Lightweight wheel



Spinergy wheel, 18 spokes



Drum brake wheel

TYRES



Right Run Tyre



Solid Tyre



Marathon Plus Evolution



Supergrip



Max Grepp



Ellipse 3R Handrim

WHEEL LOCKS



Knee lever wheel lock



Brake lever extension



Compact wheel lock



Standard brake

Quickie Life R																																																																																																																		
● = Standard ○ = No cost option □ = Cost option			€																																																																																																															
ACCESSORIES																																																																																																																		
LRF090000	● Tool kit		Std																																																																																																															
LRF090025	□ Air pump		16 €																																																																																																															
LRF090024	□ High pressure pump (0 - 11 bar)		87 €																																																																																																															
LRF090030	□ Back pack		82 €																																																																																																															
LRF090026	□ Mobile phone pocket		26 €																																																																																																															
COLOURS ⁽¹⁾ Please consult our colour catalogue to review your colour choice																																																																																																																		
	<table border="1" style="width: 100%; border-collapse: collapse;"> <thead> <tr> <th></th> <th>Frame</th> <th>Handrim</th> <th>Hub/rim</th> </tr> <tr> <th></th> <th>93 €</th> <th>68 €</th> <th>186 €</th> </tr> </thead> <tbody> <tr><td>02 Brilliant Silver</td><td>○</td><td>□</td><td>□</td></tr> <tr><td>03 Silver Matt</td><td>□</td><td>□</td><td>□</td></tr> <tr><td>06 Sun Yellow</td><td>○</td><td>□</td><td>□</td></tr> <tr><td>14 Blue</td><td>○</td><td>□</td><td>□</td></tr> <tr><td>15 Brilliant Marine</td><td>○</td><td>□</td><td>□</td></tr> <tr><td>16 Matt Marine</td><td>□</td><td>□</td><td>□</td></tr> <tr><td>19 Brilliant Purple</td><td>○</td><td>□</td><td>□</td></tr> <tr><td>21 Red Ruby</td><td>○</td><td>□</td><td>□</td></tr> <tr><td>22 Brilliant Red</td><td>□</td><td>□</td><td>□</td></tr> <tr><td>23 Matt Red</td><td>□</td><td>□</td><td>□</td></tr> <tr><td>24 Tutti Frutti Orange</td><td>○</td><td>□</td><td>□</td></tr> </tbody> </table>		Frame	Handrim	Hub/rim		93 €	68 €	186 €	02 Brilliant Silver	○	□	□	03 Silver Matt	□	□	□	06 Sun Yellow	○	□	□	14 Blue	○	□	□	15 Brilliant Marine	○	□	□	16 Matt Marine	□	□	□	19 Brilliant Purple	○	□	□	21 Red Ruby	○	□	□	22 Brilliant Red	□	□	□	23 Matt Red	□	□	□	24 Tutti Frutti Orange	○	□	□	<table border="1" style="width: 100%; border-collapse: collapse;"> <thead> <tr> <th></th> <th>Frame</th> <th>Handrim</th> <th>Hub/rim</th> </tr> <tr> <th></th> <th>93 €</th> <th>68 €</th> <th>186 €</th> </tr> </thead> <tbody> <tr><td>27 Graphitemetallic</td><td>○</td><td>□</td><td>□</td></tr> <tr><td>29 Black</td><td>○</td><td>□</td><td>□</td></tr> <tr><td>31 Matt Black</td><td>○</td><td>□</td><td>□</td></tr> <tr><td>32 Signal White</td><td>○</td><td>□</td><td>□</td></tr> <tr><td>33 Pink</td><td>○</td><td>□</td><td>□</td></tr> <tr><td>34 Dark Chocolate Metallic</td><td>□</td><td>□</td><td>□</td></tr> <tr><td>35 Skyblue</td><td>□</td><td>□</td><td>□</td></tr> <tr><td>36 Cyan-Metallic</td><td>□</td><td>□</td><td>□</td></tr> <tr><td>37 Marsred (Orange)</td><td>□</td><td>□</td><td>□</td></tr> <tr><td>40 Kiwi</td><td>□</td><td>□</td><td>□</td></tr> <tr><td>41 Flamingo-Glitter</td><td>□</td><td>□</td><td>□</td></tr> <tr><td>42 Matt-Anthraxite</td><td>○</td><td>□</td><td>□</td></tr> <tr><td>46 Mamba Green (new)</td><td>□</td><td>□</td><td>□</td></tr> </tbody> </table>		Frame	Handrim	Hub/rim		93 €	68 €	186 €	27 Graphitemetallic	○	□	□	29 Black	○	□	□	31 Matt Black	○	□	□	32 Signal White	○	□	□	33 Pink	○	□	□	34 Dark Chocolate Metallic	□	□	□	35 Skyblue	□	□	□	36 Cyan-Metallic	□	□	□	37 Marsred (Orange)	□	□	□	40 Kiwi	□	□	□	41 Flamingo-Glitter	□	□	□	42 Matt-Anthraxite	○	□	□	46 Mamba Green (new)	□	□	□
	Frame	Handrim	Hub/rim																																																																																																															
	93 €	68 €	186 €																																																																																																															
02 Brilliant Silver	○	□	□																																																																																																															
03 Silver Matt	□	□	□																																																																																																															
06 Sun Yellow	○	□	□																																																																																																															
14 Blue	○	□	□																																																																																																															
15 Brilliant Marine	○	□	□																																																																																																															
16 Matt Marine	□	□	□																																																																																																															
19 Brilliant Purple	○	□	□																																																																																																															
21 Red Ruby	○	□	□																																																																																																															
22 Brilliant Red	□	□	□																																																																																																															
23 Matt Red	□	□	□																																																																																																															
24 Tutti Frutti Orange	○	□	□																																																																																																															
	Frame	Handrim	Hub/rim																																																																																																															
	93 €	68 €	186 €																																																																																																															
27 Graphitemetallic	○	□	□																																																																																																															
29 Black	○	□	□																																																																																																															
31 Matt Black	○	□	□																																																																																																															
32 Signal White	○	□	□																																																																																																															
33 Pink	○	□	□																																																																																																															
34 Dark Chocolate Metallic	□	□	□																																																																																																															
35 Skyblue	□	□	□																																																																																																															
36 Cyan-Metallic	□	□	□																																																																																																															
37 Marsred (Orange)	□	□	□																																																																																																															
40 Kiwi	□	□	□																																																																																																															
41 Flamingo-Glitter	□	□	□																																																																																																															
42 Matt-Anthraxite	○	□	□																																																																																																															
46 Mamba Green (new)	□	□	□																																																																																																															
(1) Handrim: only with handrim colour powder coated; Hub/rim: only for universal wheel 22" or 24"																																																																																																																		
STICKER COLOURS																																																																																																																		
LRF100550	○ Sticker colour - black		-																																																																																																															
LRF100551	○ Sticker colour - silver		-																																																																																																															
ANODIZED COLOUR AXLE PLATE																																																																																																																		
LRF100580	● Axle plate anodized, black		Std																																																																																																															
LRF100581	□ Axle plate anodized, silver		105 €																																																																																																															
LRF100582	□ Axle plate anodized, orange		105 €																																																																																																															
24 " LIGHT WEIGHT WHEEL COLOURS																																																																																																																		
	● Black		Std																																																																																																															
LRF100336	□ Anodized, orange		186 €																																																																																																															
LRF100337	□ Anodized, blue		186 €																																																																																																															
LRF100338	□ Anodized, red		186 €																																																																																																															
COMMENTS FOR SPECIAL BUILD																																																																																																																		
																																																																																																																		
Quickie Life R - Basic Price			€																																																																																																															
Option price		 €																																																																																																															
Packaging and transport																																																																																																																		
Exclusive VAT																																																																																																																		
VAT.																																																																																																																		
Total Price		 €																																																																																																															
Sunrise Medical Customer service Address: Ul. Walczaka 114a, 66 400, Gorsaw, Gorzów Wlkp. Polen Tel. +48 95 737 25 14			For more information visit our webpage www.SunriseMedical.eu © Sunrise Medical 2024																																																																																																															
E-mail: cs.pl@sunrise-medical.pl Website: www.sunrisemedical.eu																																																																																																																		

ACCESSORIES



Caddy



Back pack



High pressure pump



Air pump



Mobile phone pocket

Anodized colour axle plate



Axle plate
anodized, orange



Axle plate
anodized, silver



Axle plate
anodized, black

24 " LIGHT WEIGHT WHEEL COLOURS



Lightweight wheel, anodized orange



Lightweight wheel, anodized blue



Lightweight wheel, anodized red